

# GN 147.1

Connecting clamps with mounting base for linear actuators

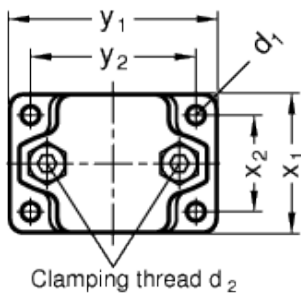

Adjustable clamping lever GN 911

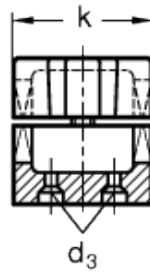
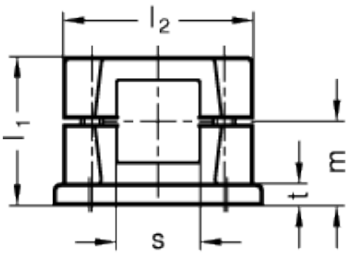
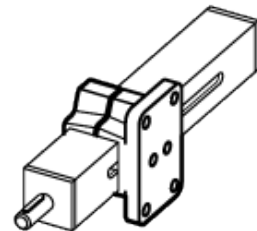
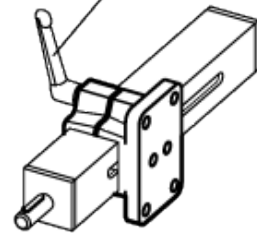

technical informations

**Material**  
Aluminium.

**Finish**

Version SW: RAL 9005 black, matte finish, epoxy resin coating.

**Clamping screws**

Identification no. 2: with AISI 304 stainless steel-clamping screw DIN 912 and nut DIN 985.

**Assembly**

The standard clamping bolts are socket cap screws DIN 912, supplied assembled. They can be replaced by clamping kits GN 911 (description see table of dimensions).

### Features and applications

Linear actuator connectors GN 147.1 are normally supplied only in connection with a mounted square linear actuator and for function control.

By means of the clamping screw and self-locking hexagonal nut (polyamide ring) the movement can either be set or the linear actuator connector can be clamped (after setting of final adjustment).

### Accessories

- Tubings [GN 990](#).
- Clamping kits [GN 911](#) (clamping handles GN 300.1 with distance bushing).
- Linear actuators GN 291.1.

Standard Elements	Main dimensions														Clamping kits	Weight
Description	s	d <sub>1</sub>	d <sub>2</sub>	d <sub>3</sub>	k	l <sub>1</sub>	l <sub>2</sub>	m	t	x <sub>1</sub>	x <sub>2</sub>	y <sub>1</sub>	y <sub>2</sub>	For d <sub>2</sub>	g	
GN 147.1-V30-2-SW	V 30	6.5	M 8	M 4	50	53	68	30	7	50	35	75	60	GN 911-M8-45	221	
GN 147.1-V40-2-SW	V 40	11	M 10	M 5	76	81.5	98	46.5	14	76	50	115	90	GN 911-M10-70	643	
GN 147.1-V50-2-SW	V 50	11	M 10	M 6	76	81.5	98	46.5	14	76	50	115	90	GN 911-M10-70	595	



STANDARD MACHINE ELEMENTS WORLDWIDE